

# Read This!

The City has modified the

## Residential Water & Wastewater Service Inspections

After **October 1, 2013** **Do Not** call the Water & Power Dispatch center to schedule any utility inspections.

The following steps are part of the new City Process:

Step 1: Application. This step remains unchanged. Submit your Residential Building Permit Application.

Step 2: Installation. After you have received your building permit and are ready to install the services; it is still the Contractor and service line installer's responsibility to install the water and wastewater service lines per the Manufacture's requirements, current requirements of the International Plumbing Code, and current Industry standards.

### **Wastewater Service Installation Recommendations:**

*Material:* PVC SDR 35 gasketed pipe and fittings (no glued joints). Schedule 40 PVC is recommended under any structural slabs (garages).

*Bedding:* 3/4" gravel or granular material (native materials are not suitable backfill). The bedding should extend a minimum of 4" under the pipe and around the pipe to a distance of 12" around the sides and the top of the pipe. Bedding materials should be placed to provide a uniform support under the pipe to prevent low spots.

*Slope:* The pipe should be laid as consistent as possible with slopes as recommended by the IPC (4": 2.08% Min/21.02% Max, 6": 1.04% Min/12.25% Max)

*Vertical Bends:* Should be used if pipe slopes reach maximum and should be supported in the recommended 3/4" gravel bedding through the vertical portion of pipe.

*Cleanouts:* Should be provided as recommended by the IPC: located not more than 100' apart and should be installed at each change of direction greater than 45 degrees.

### **Water Service Installation Recommendations:**

*Material:* Type K Copper or Copper tubing sized (CTS) High Density Polyethylene (HDPE) (needs to meet criteria for direct bury and potable water) with compression fittings. Note if using plastic pipe we recommend laying a single strand of coated 12 gage wire with the pipe for future tracing.

*Bedding:* Preference of washed sand.  
Alternative is washed pea gravel.

Please Note:  
Irrigation Sprinkler Permits are required. Instructions and permits are on the Web at:  
<http://www.cityofloveland.org/index.aspx?page=1251>

### **Step 3: Download & Complete the Water & Wastewater Service Installation Report.**

Download the form at: <http://www.cityofloveland.org/index.aspx?page=445>

The service line installer will need to sketch the as-built location of the water and wastewater services in the areas provided. The plan will need to show:

- The water service from the main to the foundation and the water meter pit location. Label the size and material used. Indicate if tracing wire was used.
- The wastewater service from the main and stub into the site to the foundation. Label the size and material used. Indicate if any vertical bends were used.
- Complete the Installer Certification and the Builder Certification

If you have any questions on the Report please contact (970) 962-3750

**Step 4: Submit the completed Water & Wastewater Service Installation Report when complete **but prior to CO**, to the Building Department:**

- 1) By Hand, drop it off at the front counter; give it to the Building Inspector
- 2) By Email to [eplan-res@cityofloveland.org](mailto:eplan-res@cityofloveland.org)
- 3) By Fax to (970) 962-2904
- 4) By US Mail

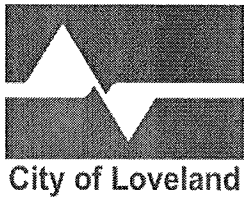

# \* SAMPLE \*

## Water & Wastewater Service Installation Report

Once complete, please submit this form to the Building Division at 500 E 3rd Street, Suite 110 or email to [epplan-res@cityofloveland.org](mailto:epplan-res@cityofloveland.org). This form is required prior to Certificate of Occupancy, but may be submitted at any time during construction. If you have any questions on this form contact (970) 962-3750.

Address: 123 Main Street  
Subdivision: Residential 2nd Sub  
Lot #: 1 Block: 2

Building Permit #: 13-00001  
Installation Date: 10/01/2013

### Water and Wastewater Service Sketch

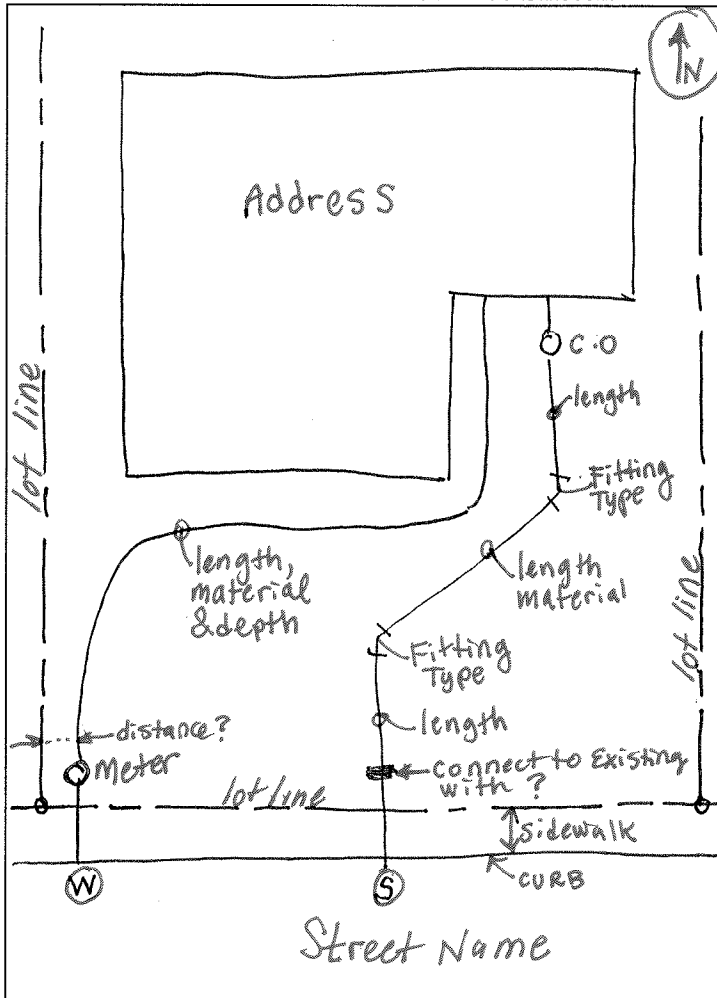

### Wastewater Profile Sketch

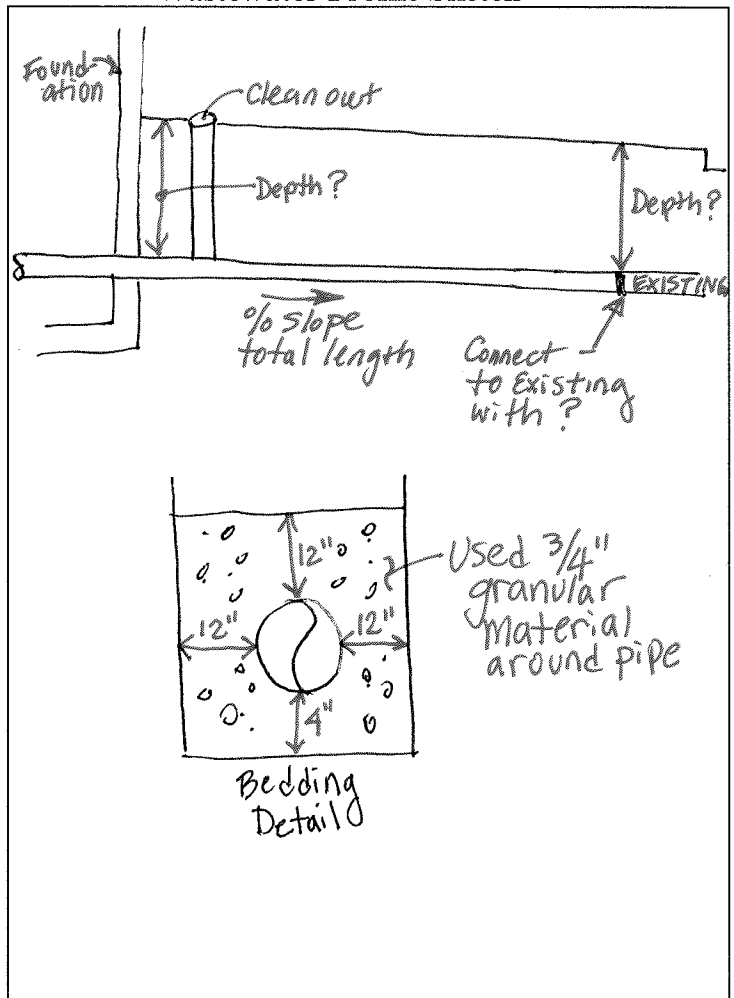

**Sketch Criteria:** Show North Arrow, lot lines, piping lengths, piping material types, depths, couplings, fittings, clean-outs, curb stop box or meter pit referenced from two locations, sidewalk with "W" and "S" each location, foundation, ground level, piping slope.

**Installer Certification:** (By signing, you are certifying that the sketch is drawn correctly.)

Company Name: Service Sub Contractor Installer name: Dan Pipe  
Address: 456 Pipe Drive Installer Signature: [Signature]  
City: Denver State: CO Zip:  Phone #: (303) 999-9999

**Builder Certification:** (By signing, you are certifying that the Installer has installed the water and sewer services as sketched.)

Company Name: Building General Superintendent name: Bill House  
Address: 789 New Home Street Superintendent Signature: [Signature]  
City: Loveland State: CO Zip: 80538 Phone #: (970) 999-9999



## Residential Water & Wastewater Service Installation Report

Email completed form to: [eplan-res@cityofloveland.org](mailto:eplan-res@cityofloveland.org). This form is required prior to Certificate of Occupancy, but may be submitted at any time during construction. If you have any questions on this form contact (970) 962-3750.

Address: \_\_\_\_\_ Building Permit #: \_\_\_\_\_  
Subdivision: \_\_\_\_\_ Installation Date: \_\_\_\_\_  
Lot #: \_\_\_\_\_ Block: \_\_\_\_\_

### Water and Wastewater Service Sketch

### Wastewater Profile Sketch

--	--

**Sketch Criteria:** Show North Arrow, lot lines, piping lengths, piping material types, depths, couplings, fittings, clean-outs, curb stop box or meter pit referenced from two locations, sidewalk with “W” and “S” each location, foundation, ground level, piping slope.

**Installer Certification:** (By signing, you are certifying that the sketch is drawn correctly.)

Company Name: \_\_\_\_\_ Installer name: \_\_\_\_\_  
Address: \_\_\_\_\_ Installer Signature: \_\_\_\_\_  
City: \_\_\_\_\_ State: \_\_\_\_ Zip: \_\_\_\_\_ Phone #: (\_\_\_\_) \_\_\_\_\_

**Builder Certification:** (By signing, you are certifying that the Installer has installed the water and sewer services as sketched.)

Company Name: \_\_\_\_\_ Superintendent name: \_\_\_\_\_  
Address: \_\_\_\_\_ Superintendent Signature: \_\_\_\_\_  
City: \_\_\_\_\_ State: \_\_\_\_ Zip: \_\_\_\_\_ Phone #: (\_\_\_\_) \_\_\_\_\_