

Open Lands Rules & Regulations

- Hours of operation are from 6:00 a.m. to 10:30 p.m. Overnight parking or camping is prohibited.
- Pets must be leashed and under human control at all times. Owners are required to pick up and remove pet waste.
- Fishing is regulated by Colorado State Regulations. Site-specific regulations apply. All persons over age 16 are required to have a Colorado Fishing License.
- Float tube/"belly boat" fishing permitted at River's Edge ponds (except Jayhawker North Pond). All other boating, swimming, wading, ice fishing, bow fishing, and ice skating are prohibited.
- Glass containers/bottles are prohibited. Alcoholic beverages are not permitted.
- No open fires or flames. No gathering or cutting firewood.
- Bicycling permitted on designated trails only. Bicyclists yield to other trail users.
- Horses (except police) are not permitted on open lands or trails.
- Motorized vehicles (except authorized) are not allowed outside of established streets and parking areas. Parking allowed in designated areas only.
- Remote control (RC) motorized vehicles are not allowed.
- Littering, graffiti or markings on open lands or facilities is prohibited.
- Discharge or use of firearms, projectiles, or fireworks is prohibited.
- Feeding, trapping, hunting, or disturbing wildlife is not permitted.
- Collecting, removing, destroying, or defacing any natural or manmade object is prohibited.
- Shade structures are available for drop-in use and are not reservable.
- Smoking is prohibited.
- Noise Ordinance is strictly enforced.
- Commercial, retail and vending activities are not allowed in City Parks, Open Lands or trails without a permit from the Parks and Recreation Department.
- Private landscaping or use of open lands, including extensions of backyard landscaping, trash or rubbish dumping, or other unauthorized use, is prohibited. Any encroachment or storage of privately owned items on open lands is prohibited.
- **Call 911 in case of Emergency.** Report maintenance concerns or vandalism to the Parks and Recreation Department at (970) 962-2727.

Parking Information

- ❖ Parking is available at Centennial Park. *There is no guarantee on the number of parking spaces available.* From this parking lot, the safest access may be gained by crossing under First St. on the Recreation Trail from Centennial Park towards the south, and then returning to the west for the Jayhawker Ponds main entrance.
- ❖ [Fishing Reports](#) are available online, through *Colorado Parks & Wildlife*.



The City of Loveland is committed to providing an equal opportunity for citizens and does not discriminate on the basis of disability, race, color, national origin, religion, sexual orientation or gender. The City will make reasonable accommodations for citizens in accordance with the Americans with Disabilities Act.

For information, email the ADA Coordinator at:

bettie.greenberg@cityofloveland.org or call (970) 962-3319.

For disabled persons needing reasonable accommodation to apply for, attend, or participate in a City service, program or activity, call the Parks & Recreation Department Administrative Office at: (970) 962-2727 or TDD (970) 962-2620 (for the hearing impaired) as far in advance as possible.

Jayhawker Ponds North & South

at River's Edge Natural Area

**Located South of Centennial Park
(corner of W. 1st St. & Taft Ave.)**



Jayhawker Ponds



City of Loveland

Parks & Recreation Department

500 E. 3rd Street, Suite 200 - Loveland

(970) 962-2727

www.CityofLoveland.org/Parks

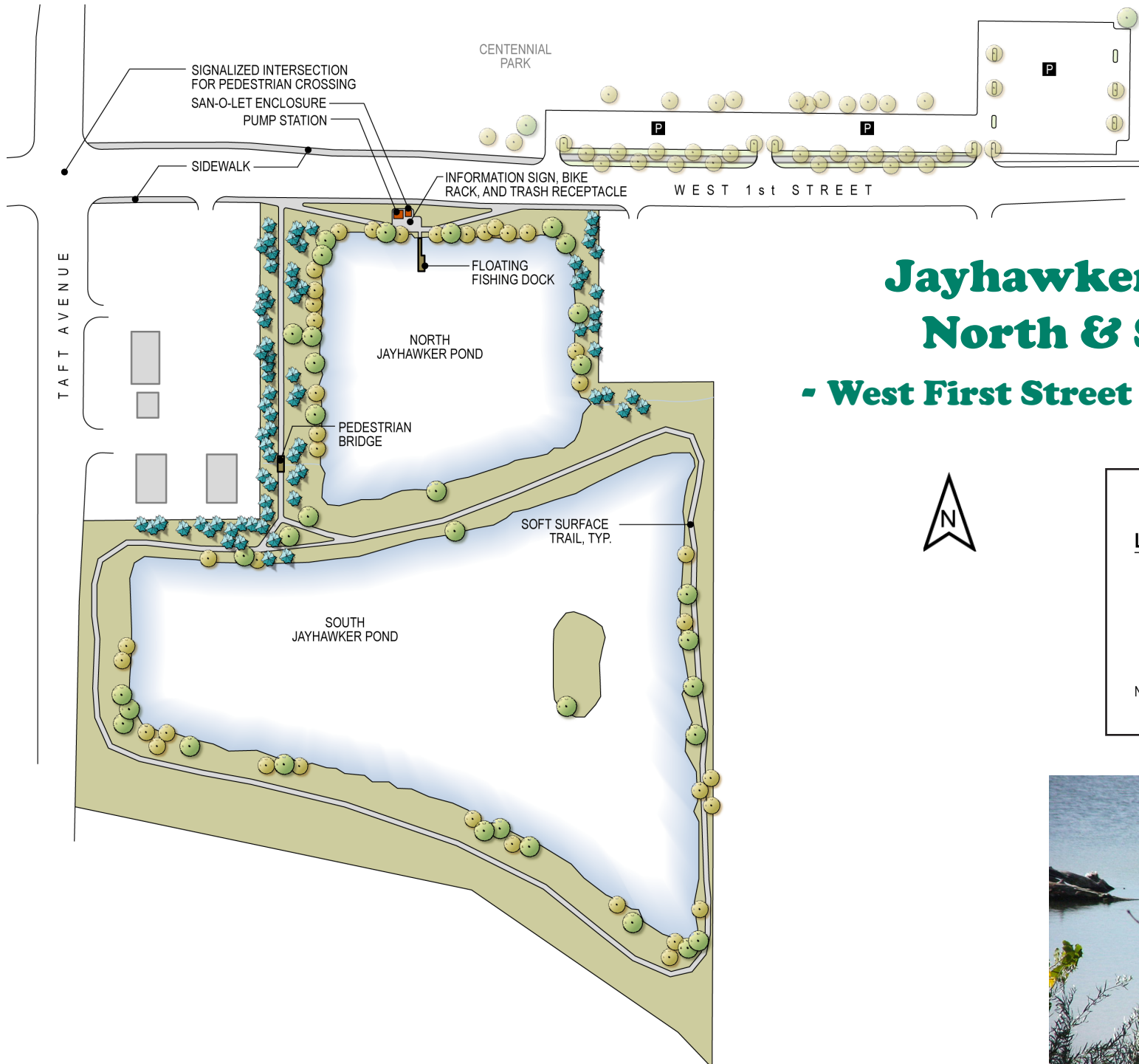



Jayhawker Ponds North & South

- West First Street & Taft Avenue



JAYHAWKER PONDS

LEGEND

-  PARKING
-  RESERVABLE SHELTER
-  TREES (APPROX. LOCATION)

Note: Legend symbol size may not match map symbol size

