

All Traffic Control Devices to Conform to the M.U.T.C.D
Carnes Services LLC Does Not Accept Any Liability if Another Company Or Individual Sets up the Traffic Control Represented on This Plan/M.H.T.

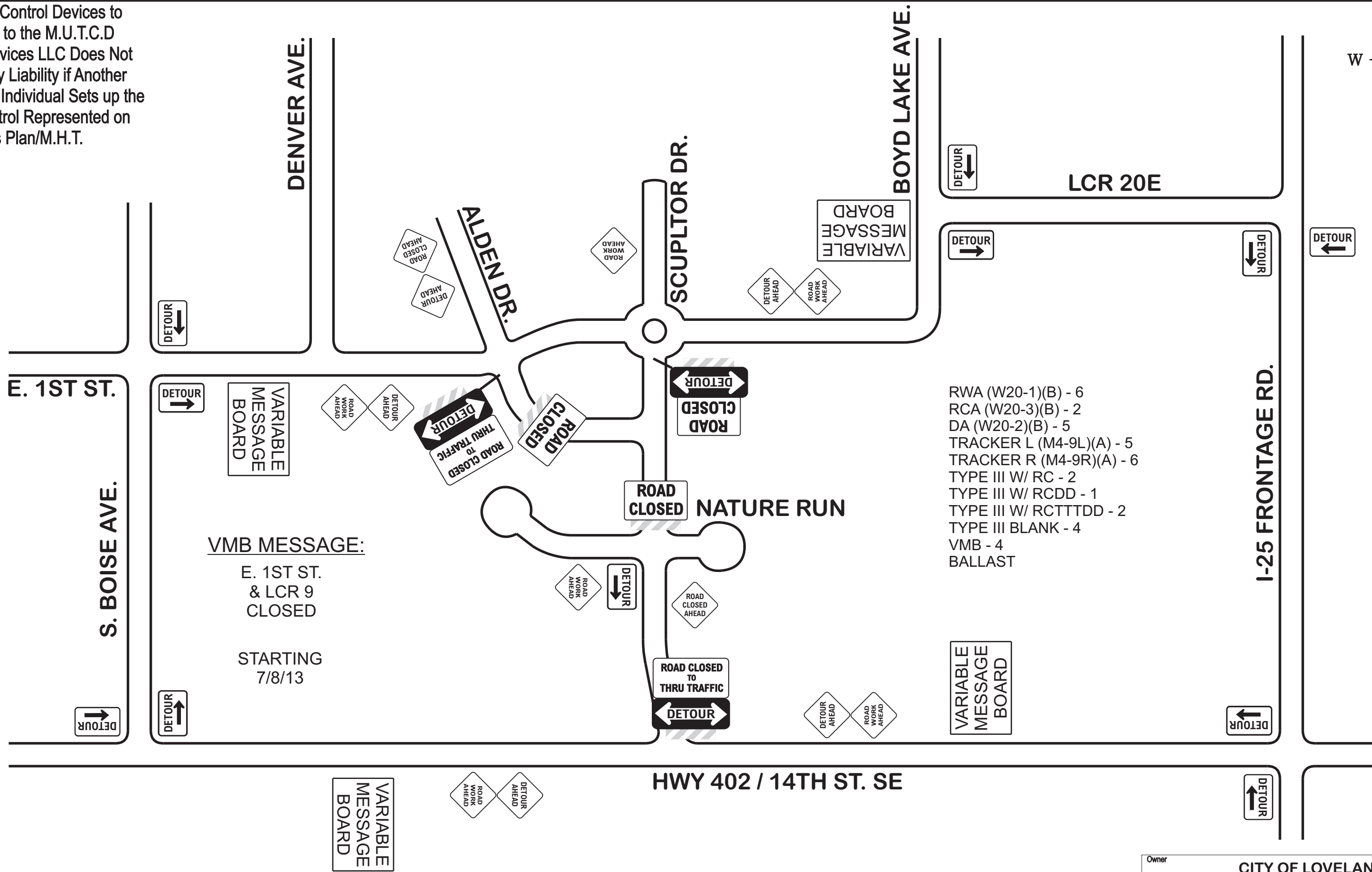
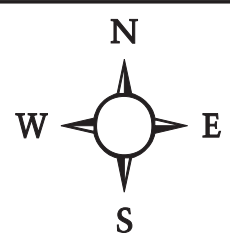

- RWA (W20-1)(B) - 6
- RCA (W20-3)(B) - 2
- DA (W20-2)(B) - 5
- TRACKER L (M4-9L)(A) - 5
- TRACKER R (M4-9R)(A) - 6
- TYPE III W/ RC - 2
- TYPE III W/ RCDD - 1
- TYPE III W/ RCTTTDD - 2
- TYPE III BLANK - 4
- VMB - 4
- BALLAST

PLAN NOT DRAWN TO SCALE.
TCP SHOWS A ROAD CLOSURE FOR CONSTRUCTION AT E 1ST ST & SCULPTOR DR.
PLAN MAY BE MODIFIED ON SITE AS NECESSARY TO SAFELY COMPLETE ALL WORK.
WORK AREA PROTECTION PROVIDED AS NEEDED.
SIGN SPACING TO BE 500' MIN. ON HWY 402 & 100' MIN. ON SIDE STREETS.

Owner	CITY OF LOVELAND		
Project Name	MILLENNIUM SW FIRST SUBDIVISION PHASE 3B		Project Number
Prime Contractor	COULSON EXCAVATING	Traffic Control Contractor CARNES SERVICES LLC	
Phone	970-568-3632	Sheet Number	Date
		1	TBA
Prepared By	JOHN KELEHER - 6/26/13		